

RJ973 SHARING IN THE WORLD

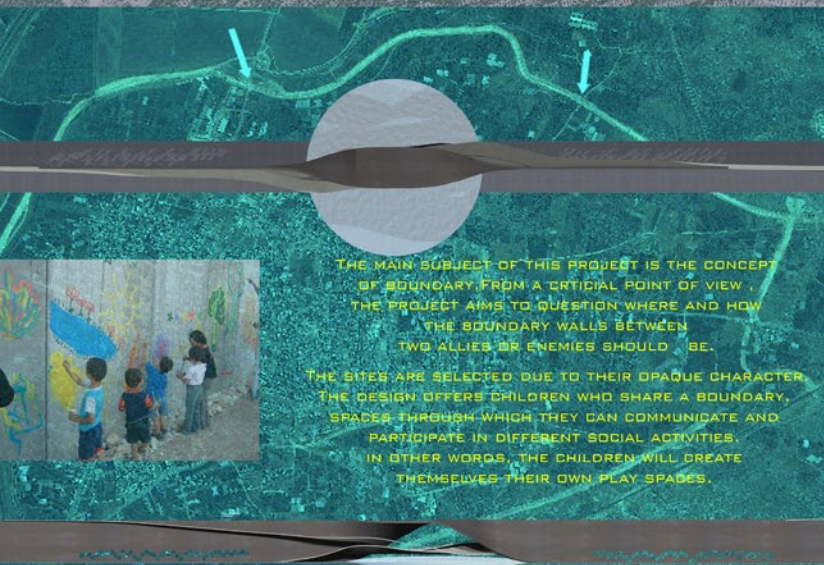

THE MAIN SUBJECT OF THIS PROJECT IS THE CONCEPT OF BOUNDARY FROM A CRITICAL POINT OF VIEW. THE PROJECT AIMS TO QUESTION WHERE AND HOW THE BOUNDARY WALLS BETWEEN TWO ALLIES OR ENEMIES SHOULD BE.

THE SITES ARE SELECTED DUE TO THEIR OPAQUE CHARACTER. THE DESIGN OFFERS CHILDREN WHO SHARE A BOUNDARY, SPACES THROUGH WHICH THEY CAN COMMUNICATE AND PARTICIPATE IN DIFFERENT SOCIAL ACTIVITIES. IN OTHER WORDS, THE CHILDREN WILL CREATE THEMSELVES THEIR OWN PLAY SPACES.

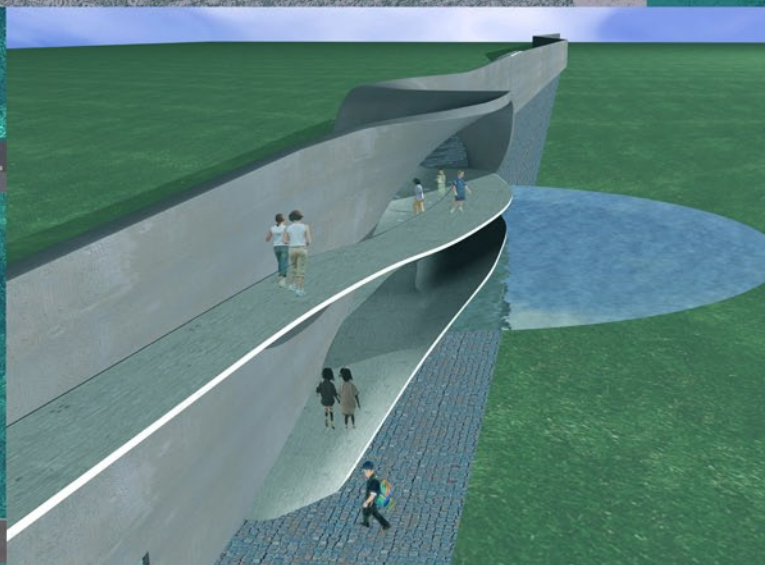

BOUNDARY WALL

THANKS TO THE PLASTICITY OF CONCRETE, THE WALL AIMS TO EMPHASIZE THE SIMPLE AND INTELLIGIBLE SPATIALITY OF ARCHITECTURE BY USING A PLAIN SKIN THAT EMBODIES A SHELTER.



BOUNDARY = REAGENT
PLASTICE = REUNION
NONOPAQUE



THE CHILDREN WILL CREATE THEMSELVES THEIR OWN PLAY SPACES.



PLATFORM AND WATER

WATER IS AN EXPRESSION OF PURITY, THROUGH THE HOLES ON THE PLATFORM, THE SUN LIGHT WHICH ILLUMINATES THE WORLD, AND SYMBOLIZES THE INTELLECTUAL LIGHT WHICH ENLIGHTENS OUR LIFE WILL BY REFLECTED ON THE SURFACE.

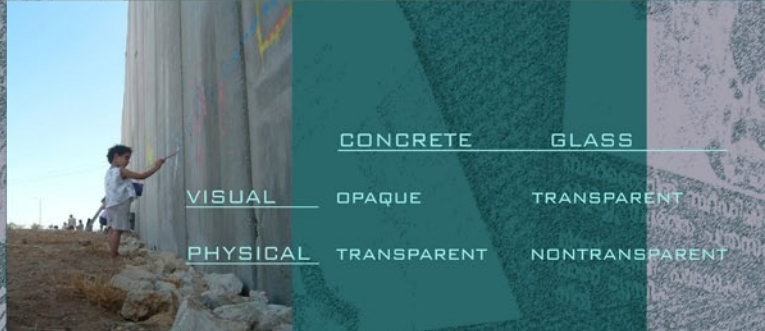
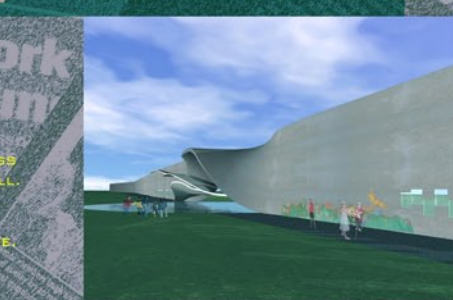

	CONCRETE	GLASS
VISUAL	OPAQUE	TRANSPARENT
PHYSICAL	TRANSPARENT	NONTRANSPARENT

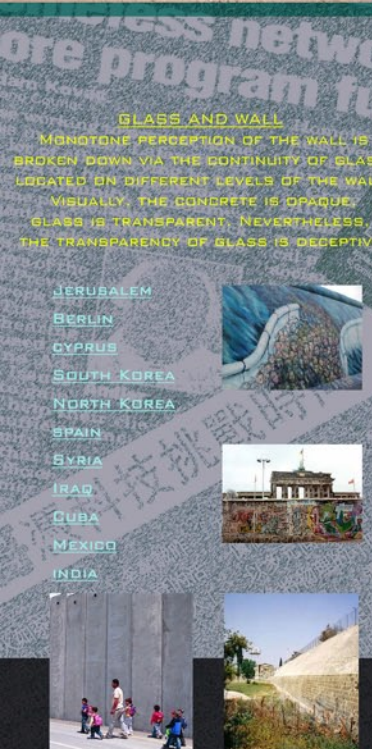

GLASS AND WALL

MONOTONE PERCEPTION OF THE WALL IS BROKEN DOWN VIA THE CONTINUITY OF GLASS LOCATED ON DIFFERENT LEVELS OF THE WALL. VISUALLY, THE CONCRETE IS OPAQUE, GLASS IS TRANSPARENT. NEVERTHELESS, THE TRANSPARENCY OF GLASS IS DECEPTIVE.

JERUSALEM
BERLIN
CYPRUS
SOUTH KOREA
NORTH KOREA
SPAIN
SYRIA
IRAQ
CUBA
MEXICO
INDIA

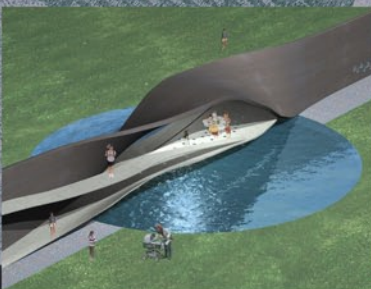

LET THE CHILDREN PLAY